

# DEVELOPMENTS



# 11

## PRACTICE PROFILE

Marchini Curran Associates is an award-winning, RIBA chartered practice of highly committed architects and interior designers providing innovative architectural design solutions.

The MCA team uses its skills and expertise to create unique designs exceeding the requirements of any brief, offering architectural, interior design and master planning services to the public, private and voluntary sectors.

MCA has designed highly successful projects in diverse market sectors including retail, leisure, education and commercial as well as large scale master planning, regeneration, office and residential buildings.

MCA designs are based on an informed use of technology and materials combining a commitment to the spirit of the new, and with an awareness of context.

MCA considers that client liaison is vital, and believes that combining quality design and rigorous analysis of concepts is key to the success of this growing team.

## WORK

When it comes to designing headquarters and office space, MCA know the best ways to unlock attractive environments where people really enjoy working.



The View, London

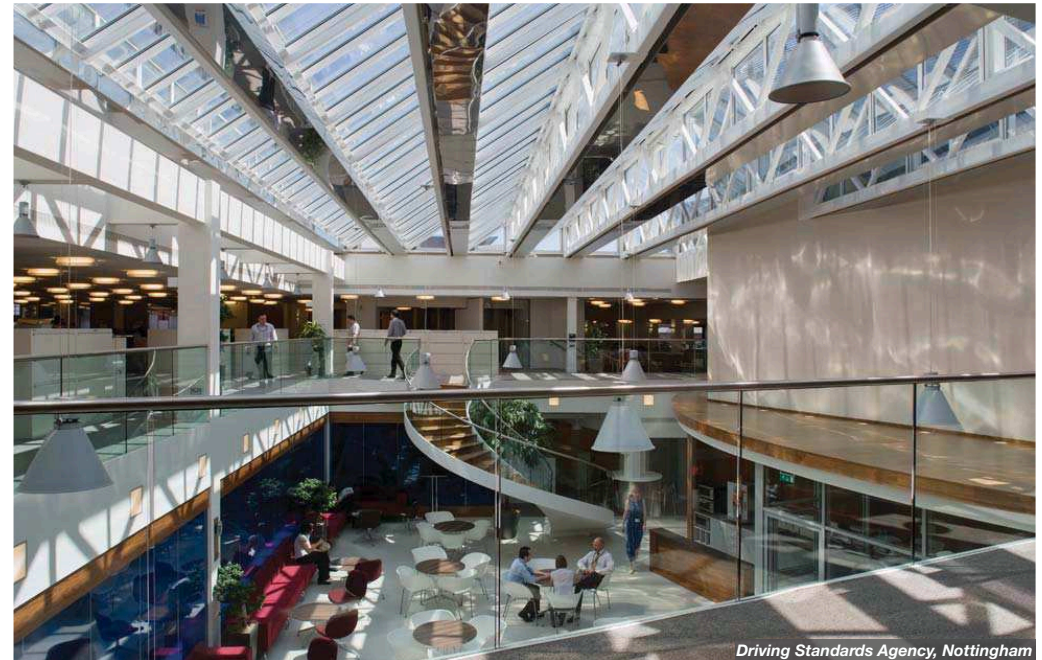

Driving Standards Agency, Nottingham



110 Wigmore Street, London



Brayford Wharf, Lincoln

### The View, London

The View, an inward investment & marketing suite overlooking the Olympic Park, offers stunning views across London and the Lower Lea Valley. It is being used by London Thames Gateway Development Corporation and partners as a vital platform in attracting and securing inward investment to the area which will be crucial to its transformation.

### 110 Wigmore Street, London

The refurbished office accommodation is located on two top floors overlooking the corner of Wigmore and Duke Street in central London. Configuration and fit out of the office interior reflects the client's ambition with bespoke design, subtle detailing and traditional high quality materials, complemented with a distinguished selection of executive furniture pieces.

### Driving Standards Agency, Nottingham

By rejuvenating this former department store, MCA has created a modern office environment by creating a new atrium, allowing light and ventilation into the heart of the deep plan building. The final design works cleverly with the unusual features of the structure.

### Brayford Wharf, Lincoln

The conversion and extension of a 1970's building will provide modern office accommodation. The works include improvements to the external envelope and provision of combined heat and power generation with low-energy mixed-mode ventilation.

## RELAX

MCA believes that it is more important than ever to create original and forward looking design solutions when working on restaurants, leisure schemes and hotels, both in the boutique and budget markets.



### Wahaca Canary Wharf, London

The new restaurant at the foot of No.1 Canada Square, Britain's tallest building, continues the successful concept of serving Mexican street food in contemporary interiors. The interior is animated by an inverted pyramid ceiling and combines corten steel with reclaimed timber cladding and polished concrete.

### Park Plaza, Leeds

The proposals for a comprehensive refurbishment include the re-organisation of lobby and bar, restaurant and lounge facilities and a revised back-of-house and service arrangement. The new plan will feature a more prominent entrance and increase the visual impact of the hotel to potential guests during day and night.

### Community Arts Centre, Cringleford

The new multifunctional pavilion will serve the expanding community of Cringleford Village and is situated within a new parkland setting at the heart of the village. The sub-divisible hall is designed to transform into a theatre for evening performances complete with bar and catering facilities for pre and post performance entertainment.



## LEARN

MCA has a proven track record in devising inventive designs for training and education centres. The award-winning team prides itself on thinking through the creation of the building - through to how people will use it.

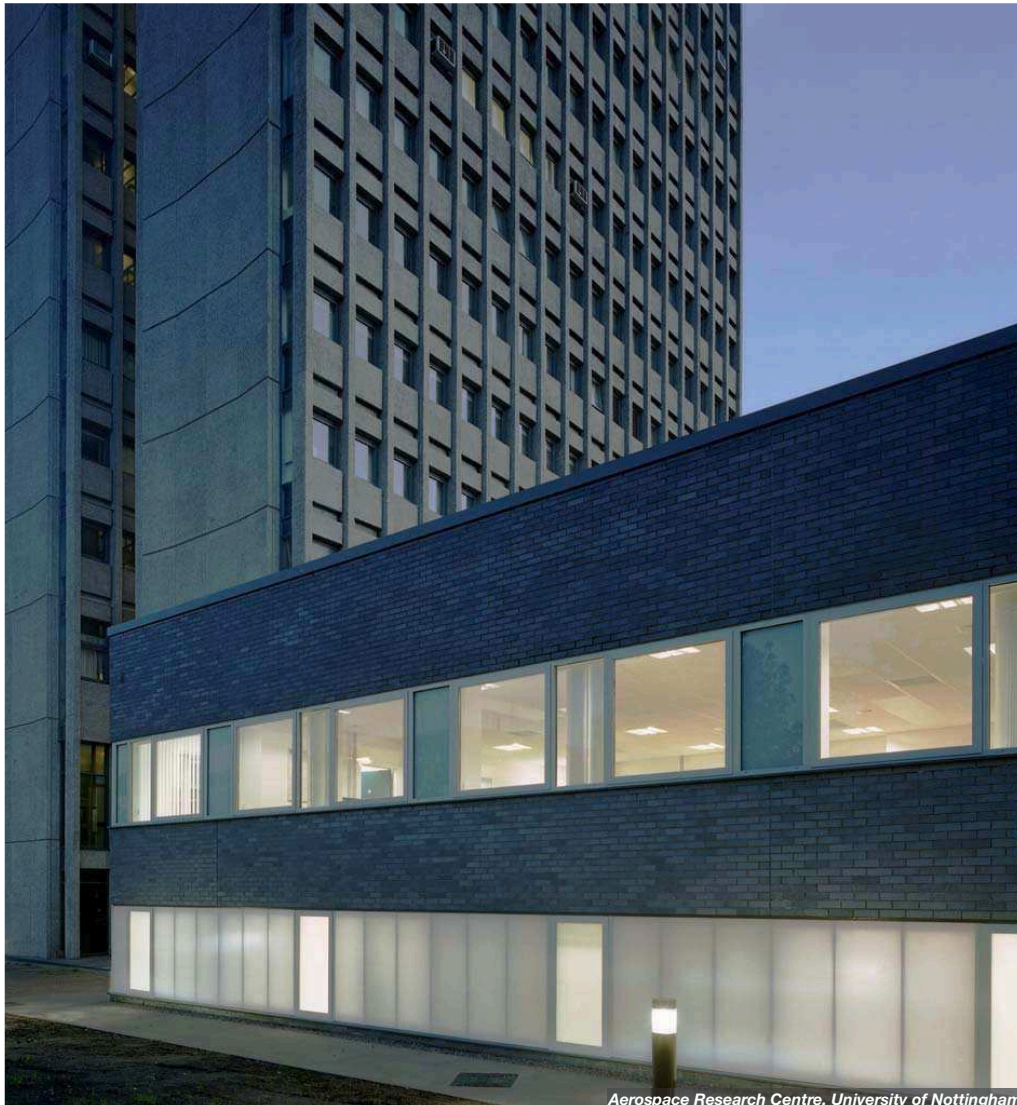

Aerospace Research Centre, University of Nottingham



VW Audi Apprentice Training Centre, Nottingham



Preparatory School Foremarke Hall, Repton

### **Aerospace Research Centre, University of Nottingham**

The extension to the Aerospace Research Centre at the University of Nottingham has increased the floor space of workshop and associated offices for academic research staff to approx 20,000sqft. The project was part-financed by the European Regional Development Fund and the building has achieved a 'Very Good' BREEAM rating.

### **Preparatory School Foremarke Hall, Repton**

The proposed Quad building will establish a new focal point within the campus and complement the impressive Main Hall. The new building will be delivered in phases and provide a new music facility and first class teaching spaces; the cloister will link the phases and frame a new courtyard.

### **VW Audi Apprentice Training Centre, Nottingham**

This purpose-built training centre for Volkswagen and Audi provides individual teaching facilities for various car manufacturers within the Volkswagen Automotive Group. The building's striking form overcame numerous planning constraints and is also be used for public events and press launches, allowing each brand to present their identity.

# LIVE

MCA makes homes that people really want to live in, whether it's a town house with garden views or an apartment in an urban setting.



Care Home, Chellaston



230 London Road, Leicester



Hildyard Road, Leicester

### Care Home, Chellaston

The care home forms an integral part of the new neighbourhood centre at Chellaston. The design of the care home combines the bespoke floor plans with a contemporary appearance that complements the adjacent residential and retail buildings on the site.

### Hildyard Road, Leicester

The 191 townhouses and apartments form the first phase of the BUSM Works redevelopment in the Abbey Meadows regeneration area, also planned by MCA. The contemporary terraces are complimented by a variety of play and amenity spaces and incorporate sustainable urban drainage; the timber framed townhouses achieve level 3 of the Code for Sustainable Homes.

### 230 London Road, Leicester

Iconic mixed-use proposal to redevelop a prominent city-centre site comprising 500m<sup>2</sup> of commercial space at ground floor and student accommodation above. The scheme provides a total of 144 bedrooms in a combination of apartments, studios and multi-bedroom clusters.

## CONSERVE

MCa has worked on numerous conservation projects – where liaison with client, planners and conservation agencies is crucial to the success of a development.



### **27 James Street, London**

The four storey terraced property, located in the Covent Garden Conservation Area, has been refurbished and extended at basement and ground floor level. Alterations to the interior including a void for a new staircase and a new shop front has created a high quality retail outlet for a single tenant.

### **Queen Street, London**

The refurbishment and conversion of two Mayfair townhouse will create luxury apartments in the most prestigious residential location in London. Each apartment has been uniquely designed and appointed to achieve a rare degree of comfort and sophistication.

### **Berkeley Square, London**

45 Berkeley Square is a Grade I listed Georgian townhouse. The historic former home of 'Clive of India', the building has been conserved and refurbished to bring it back into use as high quality offices. The development of the plans involved continuous consultation with Westminster City Council, English Heritage and the landlord's representative.

### **The Axis, Nottingham**

In the heart of the city centre conservation area, the former Co-operative department store has been retained, refurbished and significantly altered to house a large scale casino, open plan office accommodation together with other leisure and retail units. High quality penthouses complete this award-winning regeneration project.

## REVIVE

With the wider picture in mind, MCA's skill in master planning means it is helping to regenerate, rejuvenate and expand cities and towns all over the UK and abroad.



BUSM Regeneration Area, Leicester



New Town Centre, Daventry



Cocoa Beach, Brazil

### BUSM Regeneration Area, Leicester

MCA has designed proposals for a mix of town houses and apartments along a new local park opposite the National Space Centre. The scheme also incorporates retail and leisure facilities and a piazza overlooking the Grand Union Canal. A key aspiration was to make the scheme sustainable and to encourage people to walk or cycle. As a result, the master plan includes a public walkway along the canal and sustainable urban drainage systems.

### New Town Centre, Daventry

MCA has designed a mixed-use development combining a new shopping street and civic buildings containing the library and council offices. This will provide a complementary shopping environment to the existing High Street fit for the expansion of Daventry over the next 15 years.

### Cocoa Beach, Brazil

Master plan for a new beach resort of 167 acres at Belmonte, Bahia on the discovery coast of Brazil. The development will incorporate 250 individual plots for self-build villas, as well as a boutique hotel, beach club and sports centre.

## SHOPPING

MCA has the skill and knowledge to ensure that shopping schemes meet the competing needs of retailer and customer, and with a variety of big name brand clients, MCA understands working with international designer names with ambitious plans.



### Clarendon Centre, Oxford

MCA has developed proposals for the Clarendon Centre in Oxford to create a new large format store from a area of previously redundant retail space on the upper floors of the centre. The proposals also include the upgrading of some of the existing mall areas, the re-configuration of the office entrance and improvement of the public realm around Shoe Lane.

### Clarence Street, Kingston upon Thames

The re-development of the site creates a up-to-date retail accommodation over three floor and has been designed to maintain maximum flexibility for future adaptation. The proposed building generates 12% of the predicted energy use on-site through photovoltaic panels fixed to the roof and the rear elevation.

### MUJI Oxford Street, London

MCA has revitalised the store with dramatically enhanced customer flow and product presentation. The store has the rigorous calm and elegant simplicity associated with the Muji brand using signature materials of plate steel and reclaimed timber. The centre piece is a striking new staircase.

### Daventry Retail Park

Centred around a food store with an area of 85,000 square feet, the new retail park in Daventry is being developed on a brown field site previously occupied by a gas works. The site will provide complementary white goods and DIY retailing together with space for fast food operators and over 500 parking spaces. The scheme is integrated into the town centre providing good connectivity to the other nearby retail locations.

# DEVELOPMENT 12 PREVIEW



*Work*



*Revive*



*Learn*



*Live*



*Live*



*Shop*